

Grade 80 chain and accessories

8045 - Eye latch hook

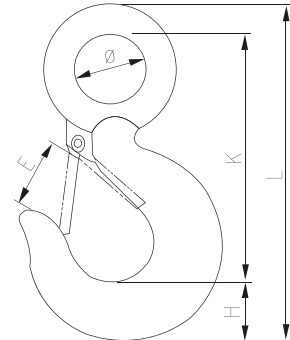

Description:

- For use with Grade 80 alloy steel chain or steel wire rope
- Suitable for overhead lifting application
- Size, CE, Traceability code, WLL & GRIPTON embossed

Standard: EN 1677

Material: Alloy steel

Factor of safety: 4 to 1

Construction: Quenched & tempered

Proof load: 2 times of working load limit

Finish: Powder coated

Eye hook with latch

Part No.	WLL/T	∅ (mm)	E (mm)	H (mm)	K (mm)	L (mm)	Weight (Kg)
8045.0112	1.12	19	22	19	80	110	0.28
8045.0200	2	28	25	25	103	140.5	0.65
8045.0315	3.15	31	27.5	28	118	162	0.94
8045.0530	5.3	39	33	35	145	201	1.95
8045.0800	8	51	40	45	180	256	3.77
8045.1250	12.5	62	51	57	230	317	6.80
8045.1500	15	73	57	70	260	360	9.80
8045.2120	21.2	89	75	76	318	434	16.25
8045.3150	31.5	90	98	91	360	495	27.2